



TRANSPORTATION CABINET

Frankfort, Kentucky 40622
www.transportation.ky.gov/

Steven L. Beshear
Governor

Michael W. Hancock, P.E.
Secretary

March 26, 2014

CALL NO. 111
CONTRACT ID NO. 141211
ADDENDUM # 2

Subject: Christian County, NHPP 0411 (017)
Letting March 28, 2014

(1) Revised - Plan Sheets - R11, X13, X14, & X15

Proposal revisions are available at <http://transportation.ky.gov/Construction-Procurement/>.

Plan revisions are available at <http://www.lynnimaging.com/kytransportation/>.

If you have any questions, please contact us at 502-564-3500.

Sincerely,

A handwritten signature in blue ink that reads "Diana Castle Radcliffe".

Diana Castle Radcliffe
Director
Division of Construction Procurement

DR:ks
Enclosures



An Equal Opportunity Employer M/F/D

REVISED 03-26-2014

| DITCH CONSTRUCTION AND LINING | | | | | | |
|-------------------------------|---------------|-------------|--------------|-----------|-------|-----------------|
| STATION TO STATION | TYPE | LINING TYPE | QUANTITY | THICKNESS | DEPTH | SHEAR STRESS |
| 41+00 RT. TO 45+00 RT. | SPEC. "V" DT. | CLASS C/ECB | 367 SQ. YDS. | N/A | N/A | 0.19 LB/SQ. FT. |

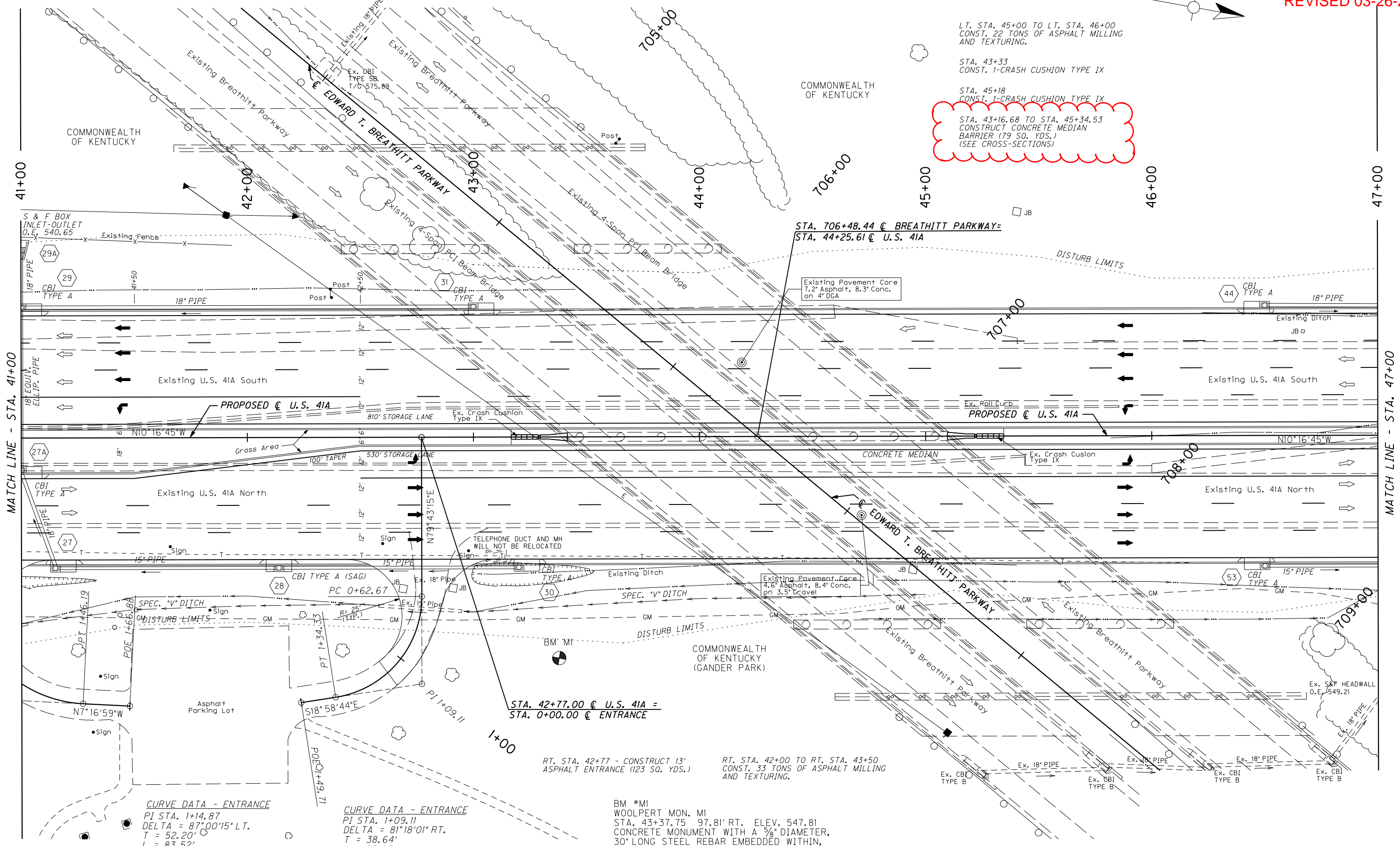

LT. STA. 45+00 TO LT. STA. 46+00
CONST. 22 TONS OF ASPHALT MILLING
AND TEXTURING.

STA. 43+33
CONST. 1-CRASH CUSHION TYPE IX

STA. 45+18
CONST. 1-CRASH CUSHION TYPE IX

STA. 43+16.68 TO STA. 45+34.53
CONSTRUCT CONCRETE MEDIAN
BARRIER (79 SQ. YDS.)
(SEE CROSS-SECTIONS)

STA. 706+48.44 @ BREATHITT PARKWAY=
STA. 44+25.61 @ U.S. 41A

Existing Pavement Core
7.2" Asphalt, 8.3" Conc.
on 4" DGA

Existing Pavement Core
4.6" Asphalt, 8.4" Conc.
on 3.5" Gravel

STA. 42+77.00 @ U.S. 41A =
STA. 0+00.00 @ ENTRANCE

RT. STA. 42+77 - CONSTRUCT 13'
ASPHALT ENTRANCE (123 SQ. YDS.)

RT. STA. 42+00 TO RT. STA. 43+50
CONST. 33 TONS OF ASPHALT MILLING
AND TEXTURING.

BM *MI
WOOLPERT MON. MI
STA. 43+37.75 97.81' RT. ELEV. 547.81
CONCRETE MONUMENT WITH A 5/8" DIAMETER,
30" LONG STEEL REBAR EMBEDDED WITHIN,
AND A STAMPED ALUMINUM DISK EMBEDDED
IN THE TOP. STAMPED WOOLPERT MI SET 2001
CONTROL STATION

CURVE DATA - ENTRANCE
PI STA. 1+14.87
DELTA = 87°00'15" LT.
T = 52.20'
L = 83.52'
R = 55.00'
E = 20.83'

CURVE DATA - ENTRANCE
PI STA. 1+09.11
DELTA = 81°18'01" RT.
T = 38.64'
L = 63.85'
R = 45.00'
E = 14.31'

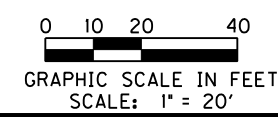

EDWARD T. BREATHITT PARKWAY
U.S. 41A PLAN
STA. 41+00 TO STA. 47+00

| DITCH CONSTRUCTION AND LINING | | | | | | |
|-------------------------------|---------------|-------------|--------------|-----------|-------|-----------------|
| STATION TO STATION | TYPE | LINING TYPE | QUANTITY | THICKNESS | DEPTH | SHEAR STRESS |
| 41+00 RT. TO 45+00 RT. | SPEC. "V" DT. | CLASS C/ECB | 367 SQ. YDS. | N/A | N/A | 0.19 LB/SQ. FT. |

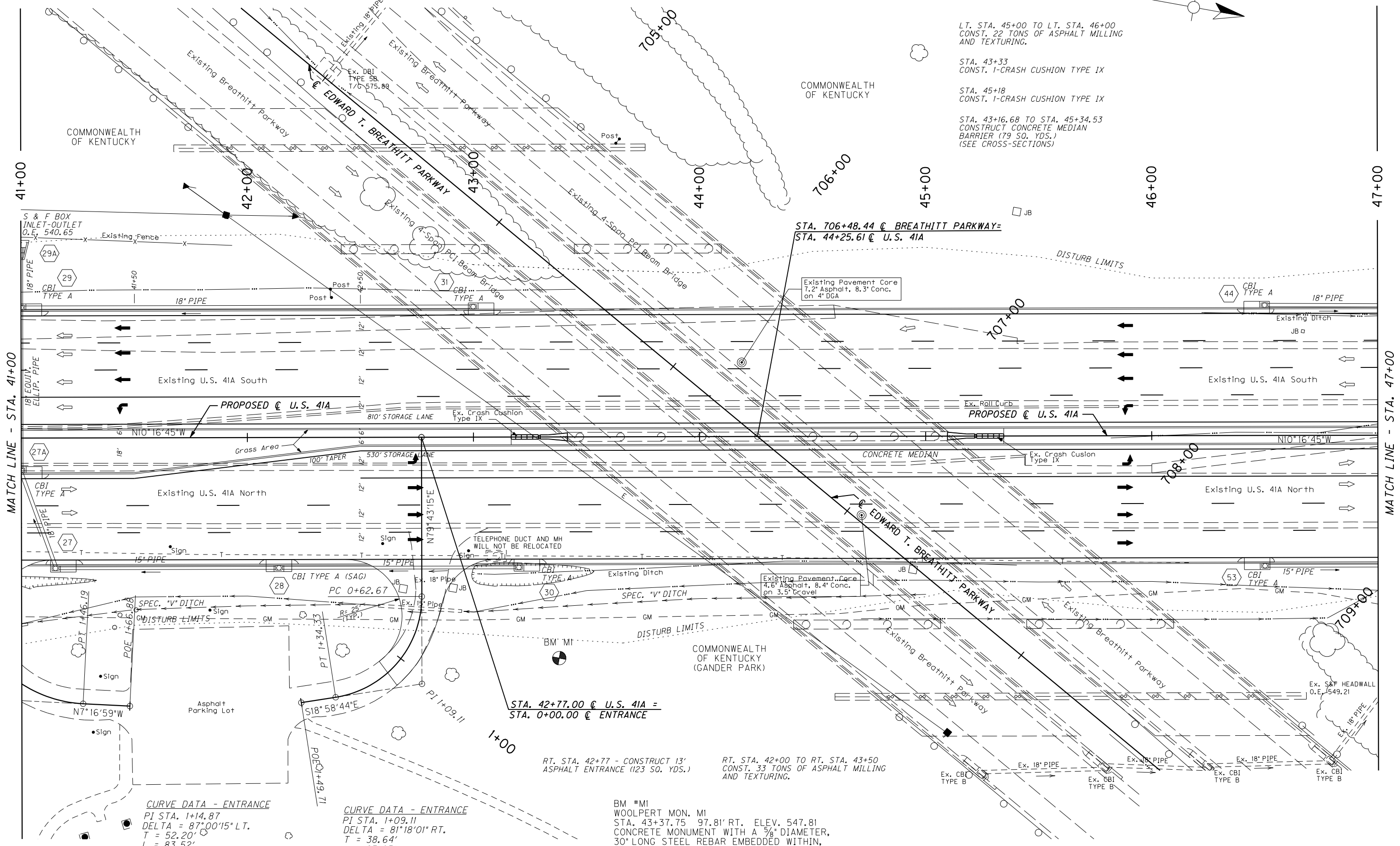
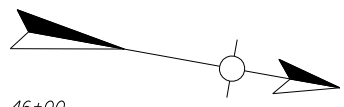

STA. 706+48.44 @ BREATHITT PARKWAY=
STA. 44+25.61 @ U.S. 41A

STA. 42+77.00 @ U.S. 41A =
STA. 0+00.00 @ ENTRANCE

RT. STA. 42+77 - CONSTRUCT 13'
ASPHALT ENTRANCE (123 SQ. YDS.)

RT. STA. 42+00 TO RT. STA. 43+50
CONST. 33 TONS OF ASPHALT MILLING
AND TEXTURING.

BM *MI
WOOLPERT MON. MI
STA. 43+37.75 97.81' RT. ELEV. 547.81
CONCRETE MONUMENT WITH A 5/8" DIAMETER,
30" LONG STEEL REBAR EMBEDDED WITHIN,
AND A STAMPED ALUMINUM DISK EMBEDDED
IN THE TOP. STAMPED WOOLPERT MI SET 2001
CONTROL STATION

CURVE DATA - ENTRANCE
PI STA. 1+14.87
DELTA = 87°00'15" LT.
T = 52.20'
L = 83.52'
R = 55.00'
E = 20.83'

CURVE DATA - ENTRANCE
PI STA. 1+09.11
DELTA = 81°18'01" RT.
T = 38.64'
L = 63.85'
R = 45.00'
E = 14.31'

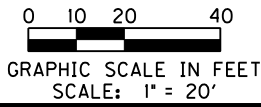

**EDWARD T. BREATHITT PARKWAY
U.S. 41A PLAN
STA. 41+00 TO STA. 47+00**

| COM. | VOLUMES (CUBIC YARDS) | | | DITCH EXC. |
|------|-----------------------|------------|-------|------------|
| | EMB. | SOLID ROCK | BENCH | |
| | 185 | 0 | 0 | 0 |
| | 172 | 0 | 0 | 0 |

| COUNTY OF | ITEM NO. | SHEET NO. |
|-----------|----------|-----------|
| CHRISTIAN | 2-100.20 | X13 |

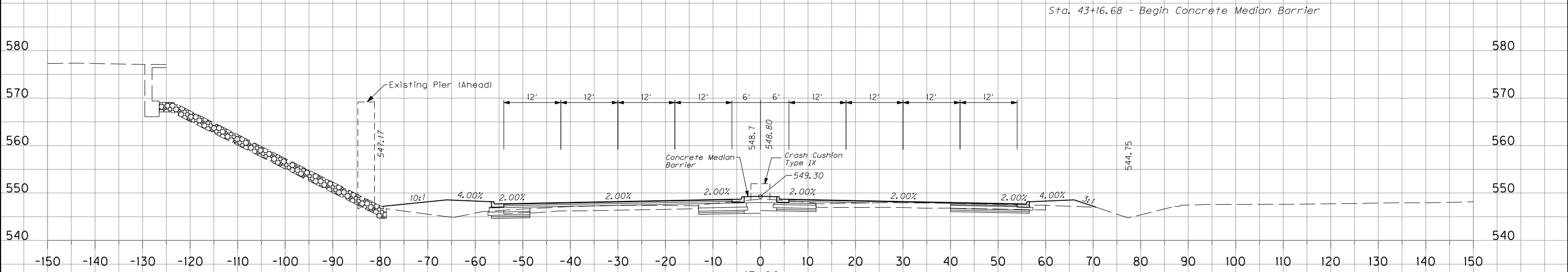

| Earthwork (Sq. ft) | Total |
|--------------------|-------|
| Cut | 103 |
| Fill | 65 |
| Emb. Fnd. Bench | 0 |
| Surf. Ditch | 0 |

| | | | | |
|-----|-----|---|---|---|
| 185 | 142 | 0 | 0 | 0 |
|-----|-----|---|---|---|

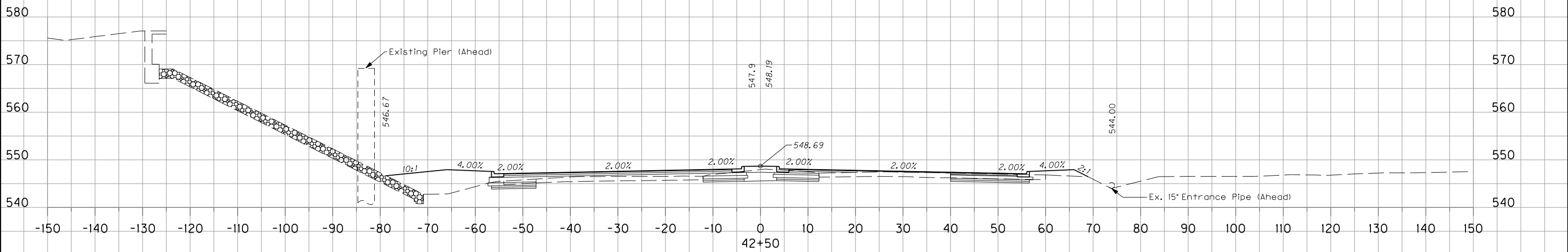

| Earthwork (Sq. ft) | Total |
|--------------------|-------|
| Cut | 97 |
| Fill | 88 |
| Emb. Fnd. Bench | 0 |
| Surf. Ditch | 0 |

| | | | | |
|-----|-----|---|---|---|
| 176 | 172 | 0 | 0 | 0 |
|-----|-----|---|---|---|

US 41A CROSS SECTIONS
STA. 42+50 TO STA. 43+00

| VOLUMES (CUBIC YARDS) | | | | |
|-----------------------|------|------------|-------|------------|
| COM. | EMB. | SOLID ROCK | BENCH | DITCH EXC. |
| | | | | |

| COUNTY OF | ITEM NO. | SHEET NO. |
|-----------|----------|-----------|
| CHRISTIAN | 2-100.20 | X13 |

REVISED 03-26-2014

Removed Note

Sta. 43+16.68 - Begin Concrete Median Barrier

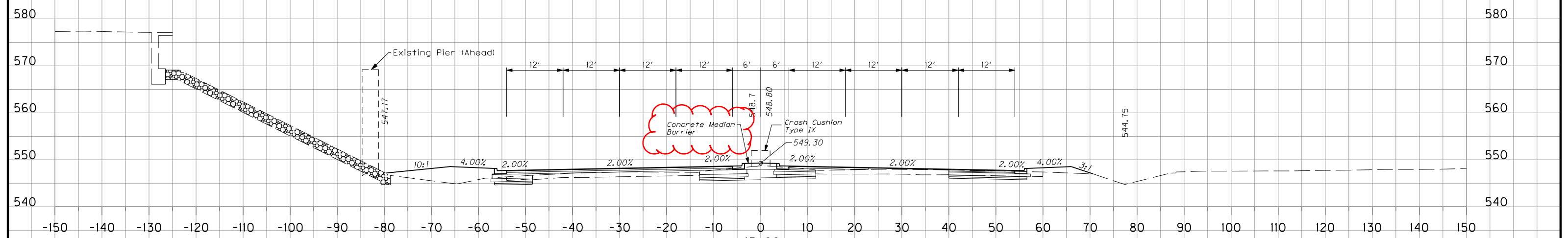

| Earthwork (Sq. ft) | Total |
|--------------------|-------|
| Cut | 103 |
| Fill | 65 |
| Emb. Fnd. Bench | 0 |
| Surf. Ditch | 0 |

| | | | | |
|-----|-----|---|---|---|
| 185 | 142 | 0 | 0 | 0 |
|-----|-----|---|---|---|

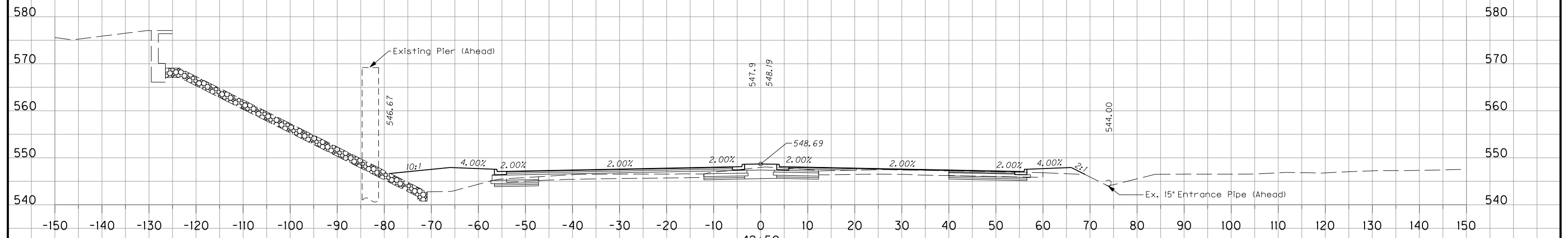

| Earthwork (Sq. ft) | Total |
|--------------------|-------|
| Cut | 97 |
| Fill | 88 |
| Emb. Fnd. Bench | 0 |
| Surf. Ditch | 0 |

| | | | | |
|-----|-----|---|---|---|
| 176 | 172 | 0 | 0 | 0 |
|-----|-----|---|---|---|

US 41A CROSS SECTIONS
STA. 42+50 TO STA. 43+00

| COM. | VOLUMES (CUBIC YARDS) | | | |
|------|-----------------------|------------|-------|------------|
| | EMB. | SOLID ROCK | BENCH | DITCH EXC. |
| | | | | |

| COUNTY OF | ITEM NO. | SHEET NO. |
|-----------|----------|-----------|
| CHRISTIAN | 2-100.20 | X14 |

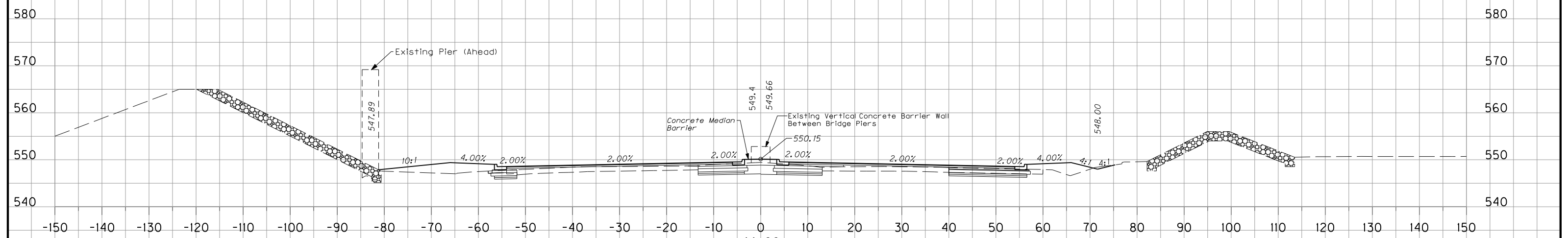

| Earthwork (Sq. ft) | Total |
|--------------------|-------|
| Cut | 101 |
| Fill | 58 |
| Emb. Fnd. Bench | 0 |
| Surf. Ditch | 0 |

| | | | | |
|-----|-----|---|---|---|
| 191 | 115 | 0 | 0 | 0 |
|-----|-----|---|---|---|

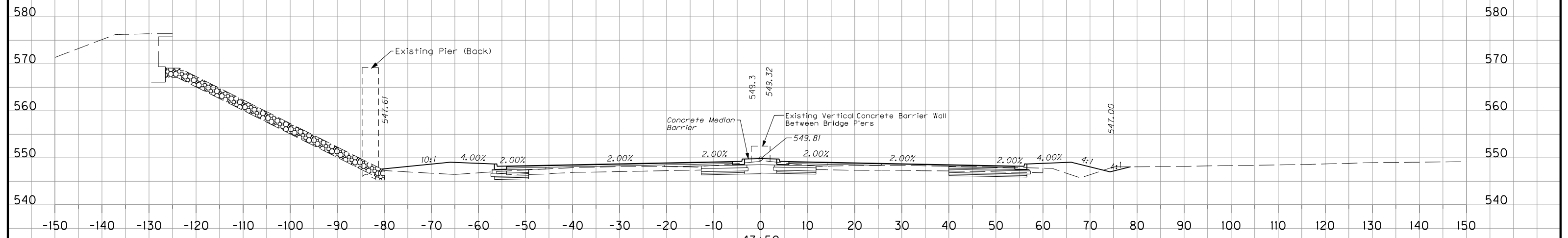

| Earthwork (Sq. ft) | Total |
|--------------------|-------|
| Cut | 105 |
| Fill | 66 |
| Emb. Fnd. Bench | 0 |
| Surf. Ditch | 0 |

| | | | | |
|-----|-----|---|---|---|
| 193 | 121 | 0 | 0 | 0 |
|-----|-----|---|---|---|

US 41A CROSS SECTIONS
STA. 43+50 TO STA. 44+00

| VOLUMES (CUBIC YARDS) | | | | |
|-----------------------|------|------------|-------|------------|
| COM. | EMB. | SOLID ROCK | BENCH | DITCH EXC. |
| | | | | |

| COUNTY OF | ITEM NO. | SHEET NO. |
|-----------|----------|-----------|
| CHRISTIAN | 2-100.20 | X14 |

REVISED 03-26-2014

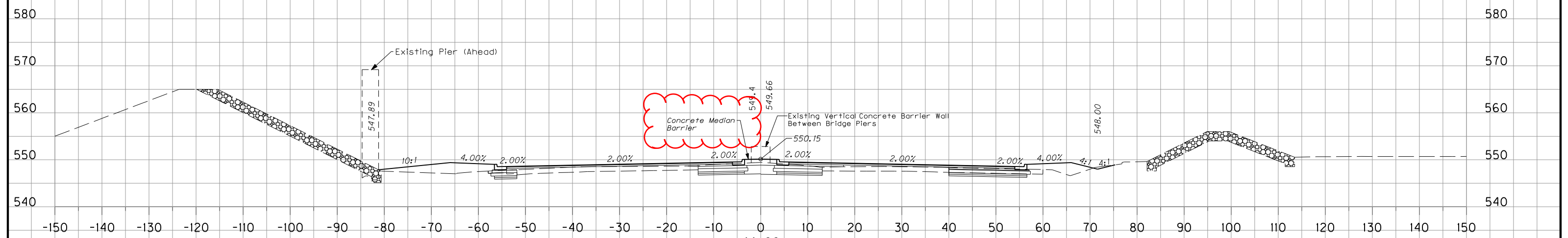

44+00

| Earthwork (Sq. ft) | Total |
|--------------------|-------|
| Cut | 101 |
| Fill | 58 |
| Emb. Fnd. Bench | 0 |
| Surf. Ditch | 0 |

| | | | | |
|-----|-----|---|---|---|
| 191 | 115 | 0 | 0 | 0 |
|-----|-----|---|---|---|

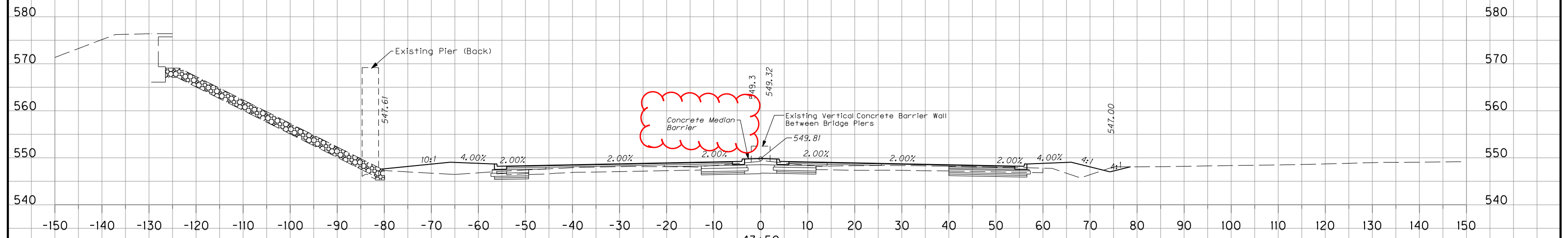

43+50

| Earthwork (Sq. ft) | Total |
|--------------------|-------|
| Cut | 105 |
| Fill | 66 |
| Emb. Fnd. Bench | 0 |
| Surf. Ditch | 0 |

| | | | | |
|-----|-----|---|---|---|
| 193 | 121 | 0 | 0 | 0 |
|-----|-----|---|---|---|

US 41A CROSS SECTIONS
STA. 43+50 TO STA. 44+00

| VOLUMES (CUBIC YARDS) | | | | |
|-----------------------|------|------------|-------|------------|
| COM. | EMB. | SOLID ROCK | BENCH | DITCH EXC. |
| | | | | |

| COUNTY OF | ITEM NO. | SHEET NO. |
|-----------|----------|-----------|
| CHRISTIAN | 2-100.20 | X15 |

Sta. 45+34.53 - End Concrete Median Barrier

Rt. Sta. 45+00 - End Spec. "V" Dt.

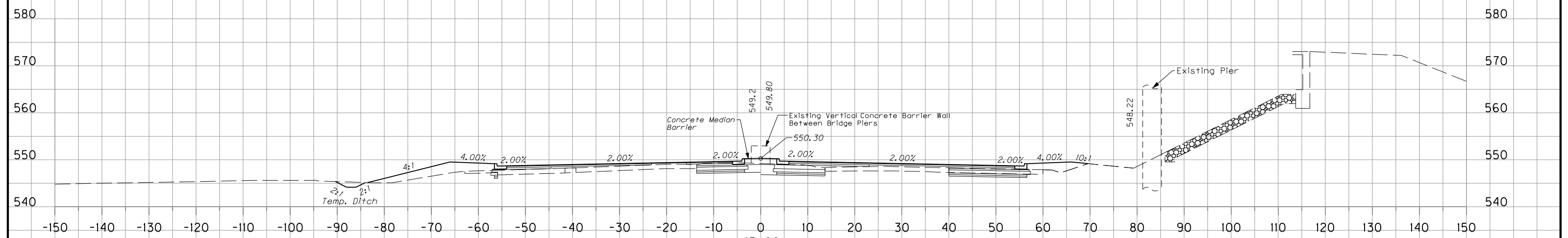

| Earthwork (Sq. ft) | Total |
|--------------------|-------|
| Cut | 96 |
| Fill | 61 |
| Emb. Fnd. Bench | 0 |
| Surf. Ditch | 0 |

| | | | | |
|-----|-----|---|---|---|
| 185 | 114 | 0 | 0 | 0 |
|-----|-----|---|---|---|

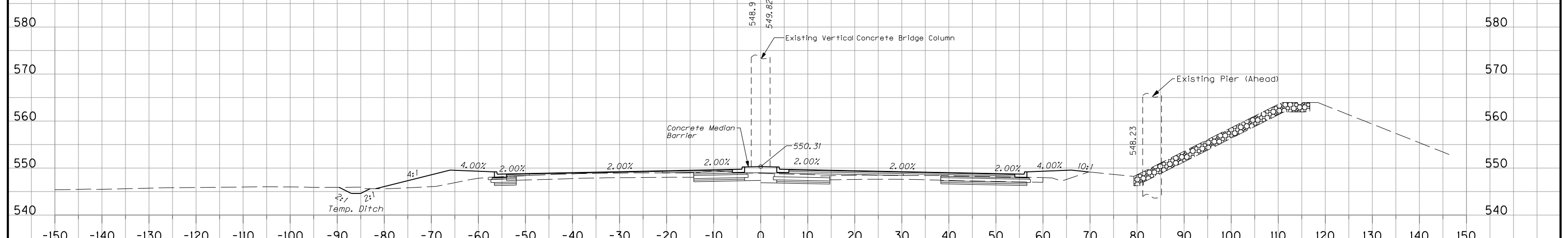

| Earthwork (Sq. ft) | Total |
|--------------------|-------|
| Cut | 104 |
| Fill | 62 |
| Emb. Fnd. Bench | 0 |
| Surf. Ditch | 0 |

| | | | | |
|-----|-----|---|---|---|
| 190 | 111 | 0 | 0 | 0 |
|-----|-----|---|---|---|

US 41A CROSS SECTIONS
STA. 44+50 TO STA. 45+00

| VOLUMES (CUBIC YARDS) | | | | |
|-----------------------|------|------------|-------|------------|
| COM. | EMB. | SOLID ROCK | BENCH | DITCH EXC. |
| | | | | |

| COUNTY OF | ITEM NO. | SHEET NO. |
|-----------|----------|-----------|
| CHRISTIAN | 2-100.20 | X15 |

REVISED 03-26-2014

Removed Notes and added New Note
 Sta. 45+34.53 - End Concrete Median Barrier

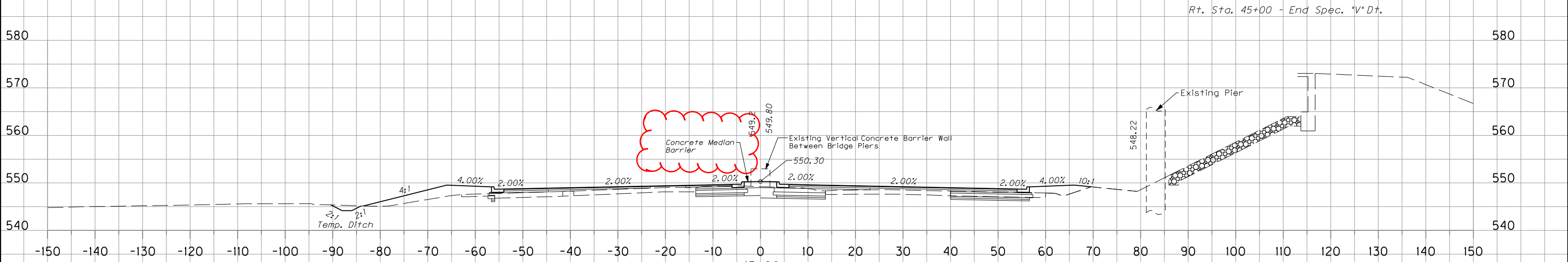

45+00

| Earthwork (Sq. ft) | Total |
|--------------------|-------|
| Cut | 96 |
| Fill | 61 |
| Emb. Fnd. Bench | 0 |
| Surf. Ditch | 0 |

| | | | | |
|-----|-----|---|---|---|
| 185 | 114 | 0 | 0 | 0 |
|-----|-----|---|---|---|

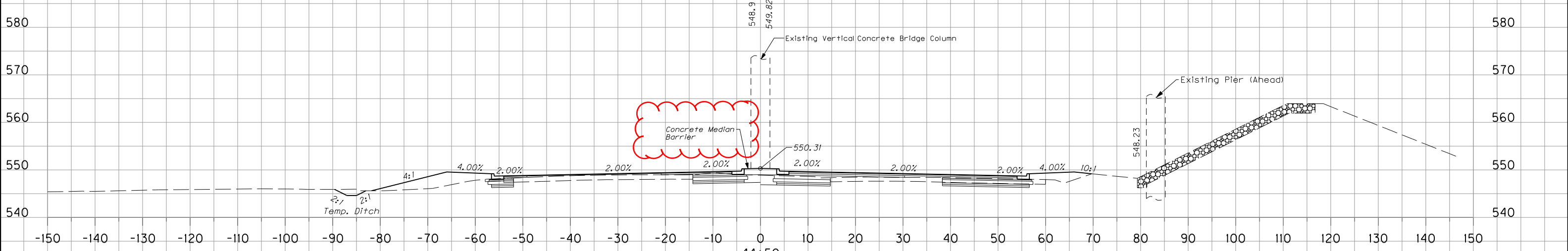

44+50

| Earthwork (Sq. ft) | Total |
|--------------------|-------|
| Cut | 104 |
| Fill | 62 |
| Emb. Fnd. Bench | 0 |
| Surf. Ditch | 0 |

| | | | | |
|-----|-----|---|---|---|
| 190 | 111 | 0 | 0 | 0 |
|-----|-----|---|---|---|

US 41A CROSS SECTIONS
 STA. 44+50 TO STA. 45+00